

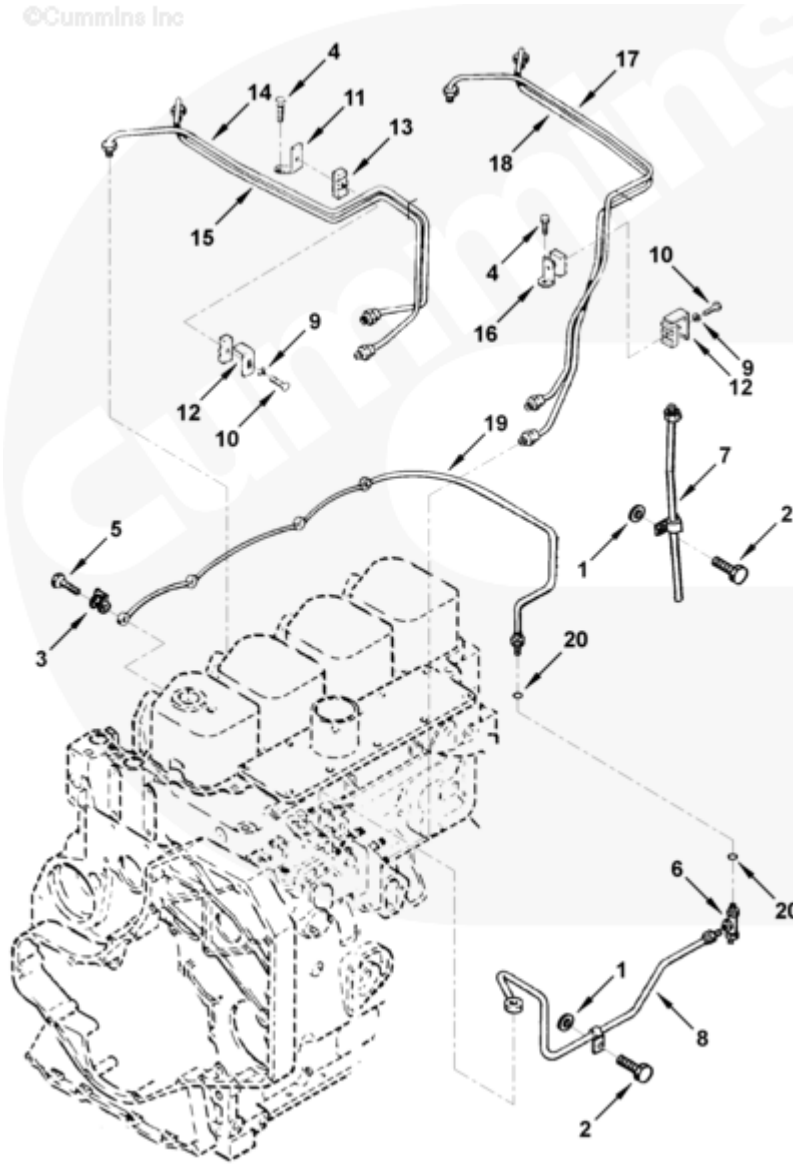

Parts Catalog - Option Detail

Electronic Parts Catalog - Option Detail				
Option	Group	Graphic	Film Card	Date
FT9775	06.03	ft900gd	T	16-JUN-95
Engines	4B3.9, 6A3.4, 6B5.9, B GAS INTERNATIONAL CM556, B4.5, B4.5 CM2350 B129B, B4.5 CM2350 B146C, B4.5 CM2350 B147B, B4.5 RGT, B4.5S, B5.9 G, B5.9 GAS PLUS CM556, B5.9 LPG, B5.9 LPG PLUS CM556, B6.7 CM2350 B121B, B6.7 CM2350 B135B, B6.7 CM2350 B136C, B6.7 CM2350 B148B, B6.7 G CMOH6.0 B125, B6.7N CM2380 B150B, B6.7S, F3.8 CM2350 F120B, F3.8 CM2350 F128C, F3.8 CM2350 F132B, F3.8 F102, G3.9, G5.9, G5.9 CM558, ISB (CHRYSLER), ISB CM2150, ISB CM2150 E, ISB CM550, ISB CM850, ISB/ISD4.5 CM2150 B119, ISB/ISD4.5 CM2150 SN, ISB/ISD6.7 CM2150 B120, ISB/ISD6.7 CM2150 SN, ISB/ISD6.7 CM2880 B126, ISB3.9 CM2220 B107, ISB4.5 CM2150, ISB5.9G CM2180, ISB6.7 2010 DCX PICKUP, ISB6.7 2013 DCX CHASSIS CAB, ISB6.7 CM2150 SQ, ISB6.7 CM2250, ISB6.7 CM2350 B101, ISB6.7 CM2350 B103, ISB6.7 CM2350 B142, ISB6.7 CM2670 B153B, ISB6.7 G CM2180 B118, ISBE CM2150, ISBE CM800, ISBE2/ISBE3 CM850, ISBE4 CM850, ISD4.5 CM2150, ISD6.7 CM2880 D101, ISF2.8 CM2220, ISF2.8 CM2220 AN, ISF2.8 CM2220 EC, ISF2.8 CM2220 ECF2, ISF2.8 CM2220 F101, ISF2.8 CM2220 F117, ISF2.8 CM2220 F122, ISF2.8 CM2220 F126, ISF2.8 CM2220 F129, ISF2.8 CM2220 IAN, ISF3.8 CM2220, ISF3.8 CM2220 AN, ISF3.8 CM2220 F103, ISF3.8 CM2220 F110, ISF3.8 CM2220 F116, ISF3.8 CM2220 F134B, ISF3.8 CM2220 IAN, ISF3.8 CM2350 F109, ISF4.5 CM2220 F123, ISG11 CM2880 G106, ISG11 CM2880 G108, ISG12 CM2880 G107, ISG12 CM2880 G109, ISG12 G CMOH6.0 G111, QSB3.9 30 CM550, QSB3.9 CM2880 B138, QSB4.5 30 CM550, QSB4.5 CM2150 B108, QSB4.5 CM2250 B131, QSB4.5 CM2250 EC, QSB4.5 CM2350 B106, QSB4.5 CM2350 B122			



ft900gd

SMALL | MEDIUM | LARGE

Cart	Ref No	Part Number	Part Description	Required	Remarks
<input type="button" value="View My Cart"/>					
		FT9775	Fuel Plumbing		2.0mm I.D. Fuel manifold...(More)
					supply and drain tubing for
					4 cylinder naturally
					aspirated or turbocharged
					engines using Bosch VE or VP
					injection pump without boost
					control below 2500 RPM.
<input type="checkbox"/>	1	3900267	Grommet Seal	2	
	2	3900630	Hexagon Flange Head Cap Screw	2	M8 X 1.25 X 20

<input type="checkbox"/>					
	3	3903380	Banjo Connector Seal	4	Replace With 4942278
<input type="checkbox"/>	4	3918109	Hexagon Flange Head Cap Screw	2	M8 x 1.25 x 25
<input type="checkbox"/>	5	3905307	Banjo Connector Screw	4	M6 X 1.00 X 14.3
<input type="checkbox"/>	6	3905388	Male Union Tee	1	
<input type="checkbox"/>	7	3905692	Fuel Drain Tube	1	
<input type="checkbox"/>	20	3905391	Grommet Seal	1	
<input type="checkbox"/>	8	3905699	Fuel Drain Tube	1	
<input type="checkbox"/>	20	3905391	Grommet Seal	1	
	9	3917712	Hexagon Head Cap Screw	4	M5 X 0.80 X 22
<input type="checkbox"/>	10	3903723	Plain Washer	4	
	11	3919292	Tube Brace	1	
<input type="checkbox"/>	12	3904711	Tube Brace	4	
<input type="checkbox"/>	13	3917746	Vibration Isolator	8	
<input type="checkbox"/>	14	3903480	Injector Fuel Supply Tube	1	#1 Cylinder
<input type="checkbox"/>	15	3903481	Injector Fuel Supply Tube	1	#2 Cylinder
<input type="checkbox"/>	16	3919294	Tube Brace	1	
<input type="checkbox"/>	17	3903482	Injector Fuel Supply Tube	1	#3 Cylinder
<input type="checkbox"/>	18	3903483	Injector Fuel Supply Tube	1	#4 Cylinder
<input type="checkbox"/>	19	3909695	Fuel Manifold	1	
<input type="checkbox"/>	20	3905391	Grommet Seal	1	
<input type="checkbox"/>	21	3910588	Tube Brace	1	
<input type="checkbox"/>	22	3910589	Tube Brace	1	